

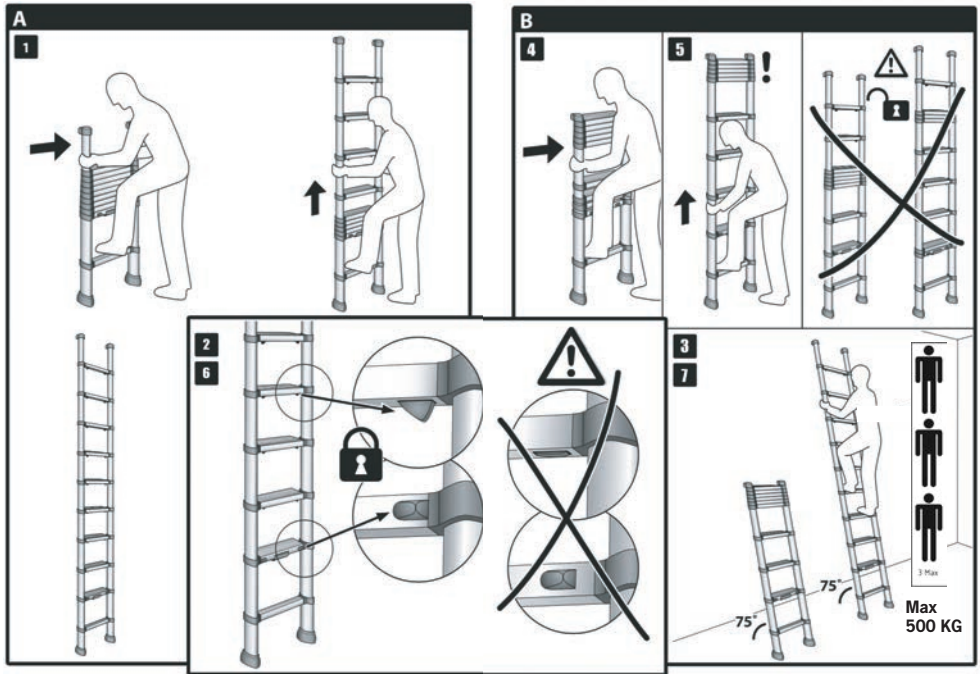

No.1 in telescopic work tools





BEFORE USE

- If the ladder is delivered with stabilizer bar(s), the bar(s) should be fixed by the user before use of the ladder.
- Inspect the ladder after delivery and before use to confirm condition and operation of all parts.
- Do not use a damaged ladder.
- Ensure that you are fit enough to use a ladder. Certain medical conditions or medication, alcohol or drug abuse could make ladder use unsafe.
- Ensure the ladder is suitable for the task.
- Remove any contamination from the ladder such as wet paint, mud, oil or snow.
- For professional use a risk assessment should be carried out respecting the legislation in the country of use.
- Identify any electrical risks in the work area, such as overhead lines or other exposed electrical equipment and do not use the ladder where electrical risks occur.
- Make sure all locking mechanisms for all extended rungs/steps are checked and locked before use.
- The ladder shall be used/stored in temperatures between -20 - +60 degrees °C.

BEFORE USE, ALWAYS CHECK;

- The stiles (uprights) are not bent, bowed, twisted, dented, cracked or corroded
- The telescopic tubes around the fixing points for other components are in good condition
- Fixings (usually rivets, screws or bolts) are not missing, loose or corroded
- Rungs are not missing, loose, excessively worn, corroded or damaged
- Hinges between front and rear sections are not damaged, loose or corroded
- Guide brackets are not missing, damaged, loose or corroded and engage properly on the mating stile
- Rubber feet and end caps are not missing, loose, excessively worn, corroded or damaged
- The entire ladder is free from contaminants (e.g. dirt, mud, paint, oil or grease)
- Locking catches are not damaged or corroded and function correctly

If any of the above checks cannot be fully satisfied, you should NOT use the ladder.

A OPENING THE LADDER

1. Position the ladder upright on a firm surface. Place one foot on the bottom rung. Begin to open the ladder from the top by pulling it upwards until the rung section locks and continue doing so rung by rung until all sections are locked.
2. Check that the red locking device under each rung is visible, which indicates that the section is locked. The second step from the bottom has sliding buttons. These are locked when they have snapped out against the tube.
3. Position of the ladder should be in an angle of 65-75 degrees for optimal safety. The rungs must be horizontal.

B OPENING THE LADDER TO ANY INTERMEDIATE LENGTH

4. Position the ladder upright on a level surface. Place one foot on the bottom rung. Take hold around the rung, which you choose to be the upper rung and pull upwards until the section locks.
5. Continue to open the ladder until all the sections below are extended and locked. The remaining sections should be stacked on top of each other.
6. Check that the red locking device under each rung is visible, which indicates that the section is locked. The second step from the bottom has sliding buttons. These are locked when they have snapped out against the tube.
7. Position the ladder in an angle of 65-75 degrees for optimal safety. The rungs must be horizontal.

C CLOSING THE LADDER

8. Clean the ladder if required (see below).
9. The entire ladder is unlocked by using the sliding buttons on the second rung from the bottom. Unlock one sliding button at a time while holding the stile of the upright ladder with your other hand (so it does not collapse by its own weight).
10. Close the ladder carefully by holding both hands on the stiles in such a way so you do not catch your fingers.

USE

- The maximum total load is 500 kg.
- Do not climb on the last meter of the ladder.
- Do not use the ladder on unfirm surface.
- Do not overreach.
- Maximum three persons on the ladder at a time
- Face the ladder when ascending and descending.
- Keep a secure grip on the ladder when ascending and descending. Maintain a handhold whilst working from a ladder or take additional safety precautions if you cannot.
- Avoid work that imposes a sideways load on ladders, such as side-on drilling through solid materials.
- Do not carry equipment which is heavy or difficult to handle while using a ladder.
- Wear suitable footwear when climbing a ladder.
- Ladders should only be used for light work of short duration (tiredness is a risk).
- Do not use the ladder outside in adverse weather conditions, such as strong wind.
- When positioning the ladder take into account risk of collision with the ladder e.g. from pedestrians, vehicles or doors. Secure doors (not fire exits) and windows where possible in the work area.
- Do not use the ladder as a bridge.
- Do not modify the ladder design.
- Do not move a ladder while standing on it.
- Do not use the ladder for dirty work or in dirty environments. If, for example, the ladder is used for bricklaying, concreting or painting, over time it may be hard to keep it clean, impairing the telescopic function.
- This ladder is for professional use.
- The ladder shall be used in the correct position, with an angle of 65-75° in relation to the ground.
- Make sure the steps are in horizontal position.
- Ladders used for access to a higher level shall be extended at least 1 m above the landing point and secured, if necessary.
- Only use the ladder in the direction as indicated. The ladder must not be opened, closed or used upside down.
- Do not lean the ladder against unsuitable surfaces.
- Ladder shall never be moved from the top.

CLEANING

For safety and functionality reasons the ladder, particularly the stiles and rungs, must always be kept clean. Dirt, filings, paint spots, glue etc. must be wiped away before the ladder is closed. Clean the ladder using a rag and a small amount of solvent. If needed, when clean, the telescopic tubes can be treated with silicon spray. Spray in the tube and wipe dry. The ladder must always be kept dry so that dust does not impair its functionality.

SERVICE & MAINTENANCE

Any service or repair work must always be carried out by an authorized service workshop, which determines suitable action in each individual case. Please contact the producer or distributor for service & maintenance.

If rubber feet or end-caps are getting worn, replace these for optimal safety. Never use the ladder without rubber feet (slip protection) and end-caps to prevent dust, metal chips or similar from getting into the tubes. New feet/end caps can be obtained from retailers. Only original spare parts may be used for safety reasons.

In case of service or repair contact your retailer to find the location of your nearest authorized service partner.

TRANSPORT & STORAGE

Always carry and transport the ladder completely closed and compacted to protect the telescopic tubes from any damage that can impair the functionality of the ladder.

The ladder shall be stored:

- Away from areas where its condition could deteriorate more rapidly (e.g. dampness, excessive heat, exposed to the elements)
- Where it cannot be damaged by vehicles, heavy objects, or contaminants.
- Where it cannot cause a trip hazard or an obstruction.
- Where it cannot be easily used for criminal purposes.
- Permanently positioned (e.g. scaffolding), or/and secured against unauthorized climbing (e.g. by children)

GUARANTEE CONDITIONS

The manufacturer guarantees that the product is free from material or manufacturing faults. If material or manufacturing faults, or damage due to material or manufacturing faults, can be proven, the buyer is entitled to have the product repaired or replaced in accordance with the local laws concerning sales of consumer goods in the country of purchase.

The manufacturer is responsible for faults in the product, for one year from the purchase date.

The manufacturer is not responsible for faults in the product, if it is clear that the fault is due to it:

- Not being used as described in the instructions.
- Not being cleaned, cared for, maintained, stored or transported in accordance with the instructions.
- Being rebuilt, modified or subjected to other external damage or accident unintentionally being damaged by any object or substance.
- Being overloaded
- Being repaired by an unauthorized service partner or if non-original spare parts have been used.
- Being incorrectly set up.

Normal wear and tear are not considered as faults.

Proof of purchase must be presented for any guarantee claims. If the purchaser wishes to make a claim regarding a fault, the retailer must be notified of the fault within a reasonable time after the fault has been discovered, or within the time period regulated by the country of purchase.



Telesteps AB
Box 362, 573 24 Tranås, Sweden

www.telesteps.com

© Copyright Telesteps AB 2019

100-1561-03 Ver.2019.1